

Public Realm Uplift

PUBLIC REALM AREAS						
	Existing (sqm)			Proposed (sqm)		
	Hardscape	Landscape	Total	Hardscape	Landscape	Total
P / 00H	2,800	521	3,321	2,728	2,027	4,755
UG / 00	2,386	590	2,976	4,049	1,385	5,434
LG	360	2,423	2,783	759	2,084	2,843
Total sqm	5,546	3,534	9,080	7,536	5,496	13,032
Total sqft	59,697	38,040	97,736	81,117	59,158	140,275

	Area Difference (sqm)		
	Hardscape	Landscape	Total
	-72	1,506	1,434
	1,663	795	2,458
	399	-339	60
Total sqm	1,990	1,962	3,952
Total sqft	21,420	21,119	42,539

The proposal achieves an overall uplift for total public realm area of 43.5%

Note - this figure does not include the public terrace area at Rotunda (12th Floor)

Public Realm Uplift

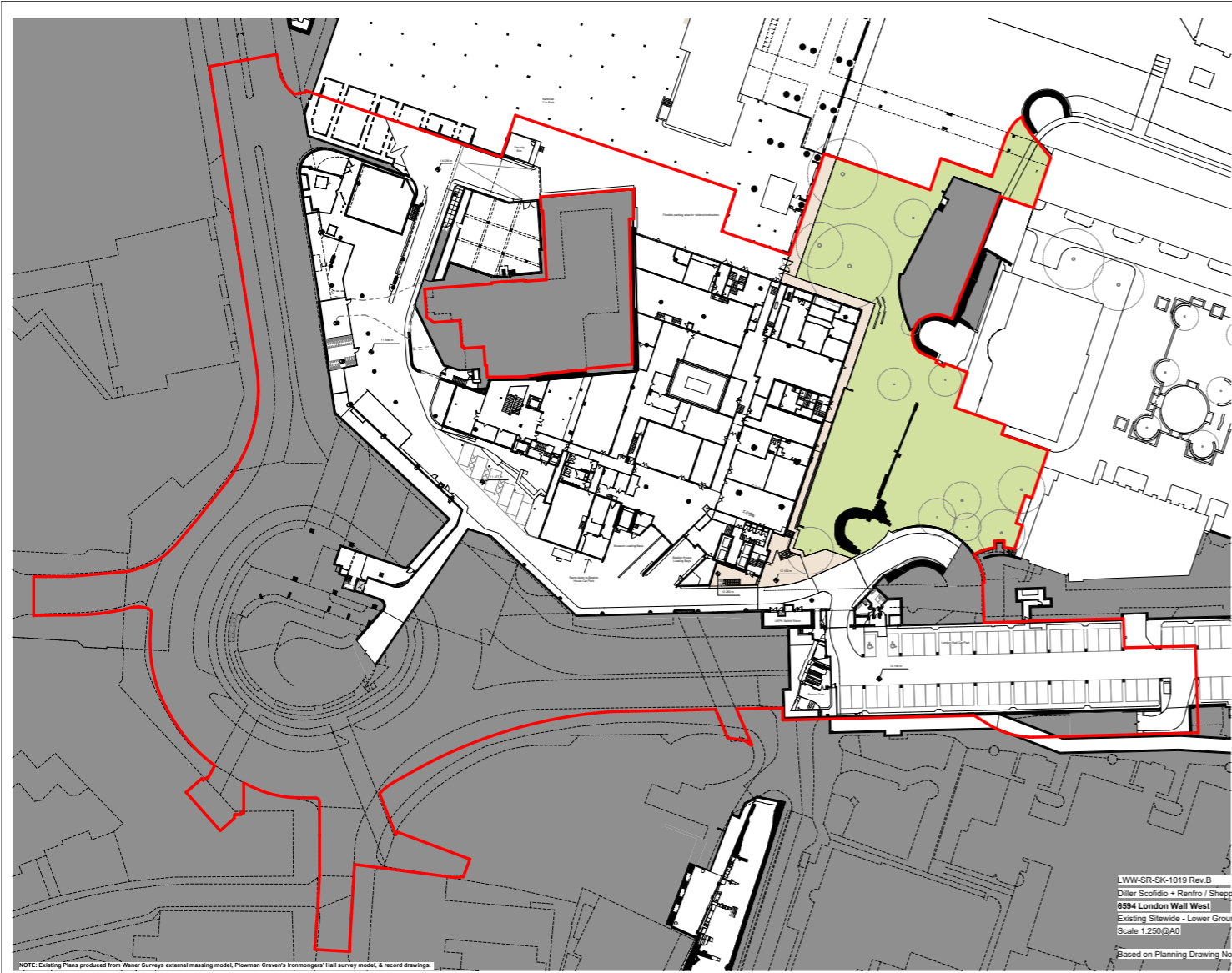

Existing

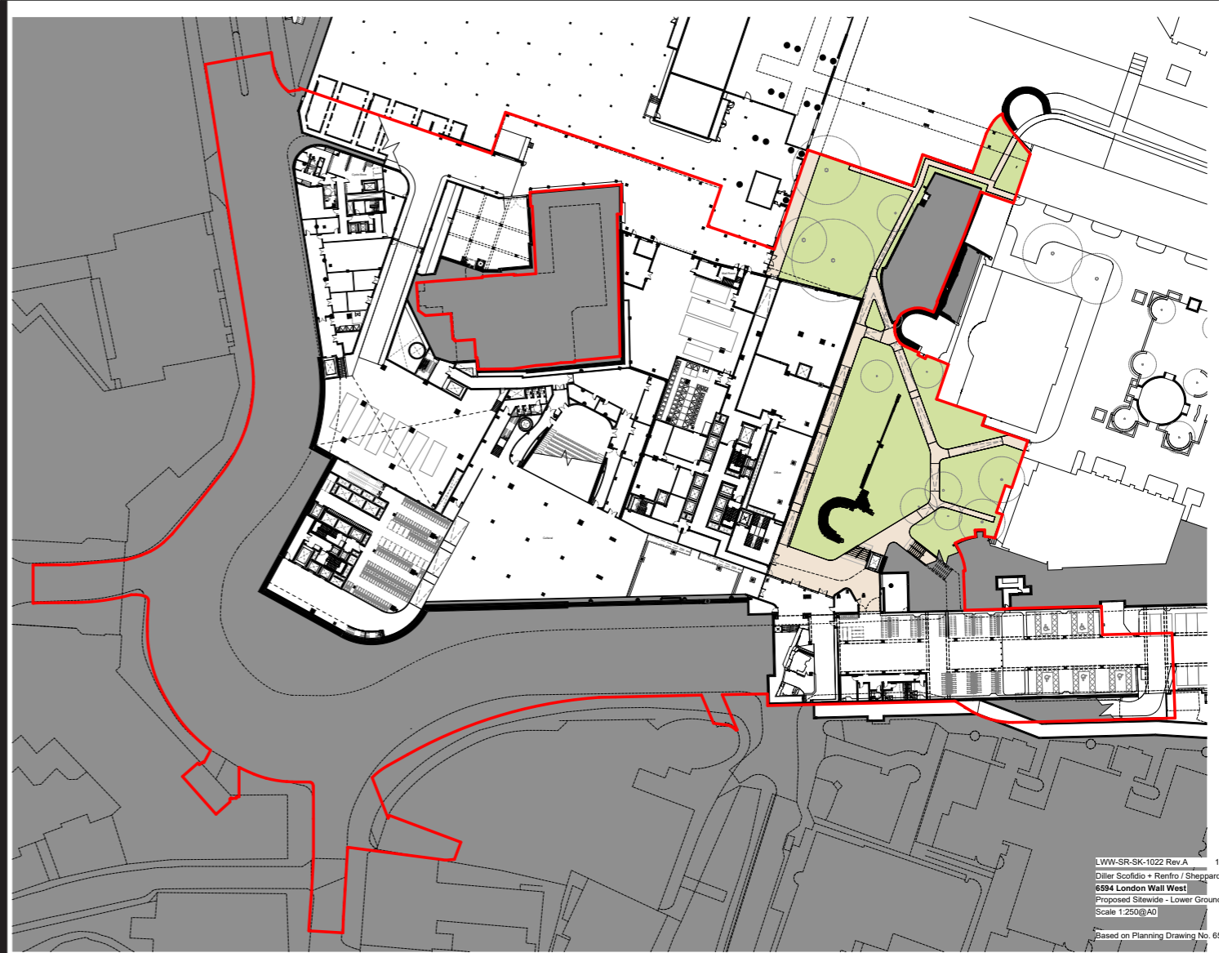

Proposed

- PUBLIC REALM**
- Landscape Area = 2,423 sqm
 - Hardscape Area = 360 sqm
 - Application Boundary for Planning Permission (Ground Floor and Below)

Public Realm Uplift

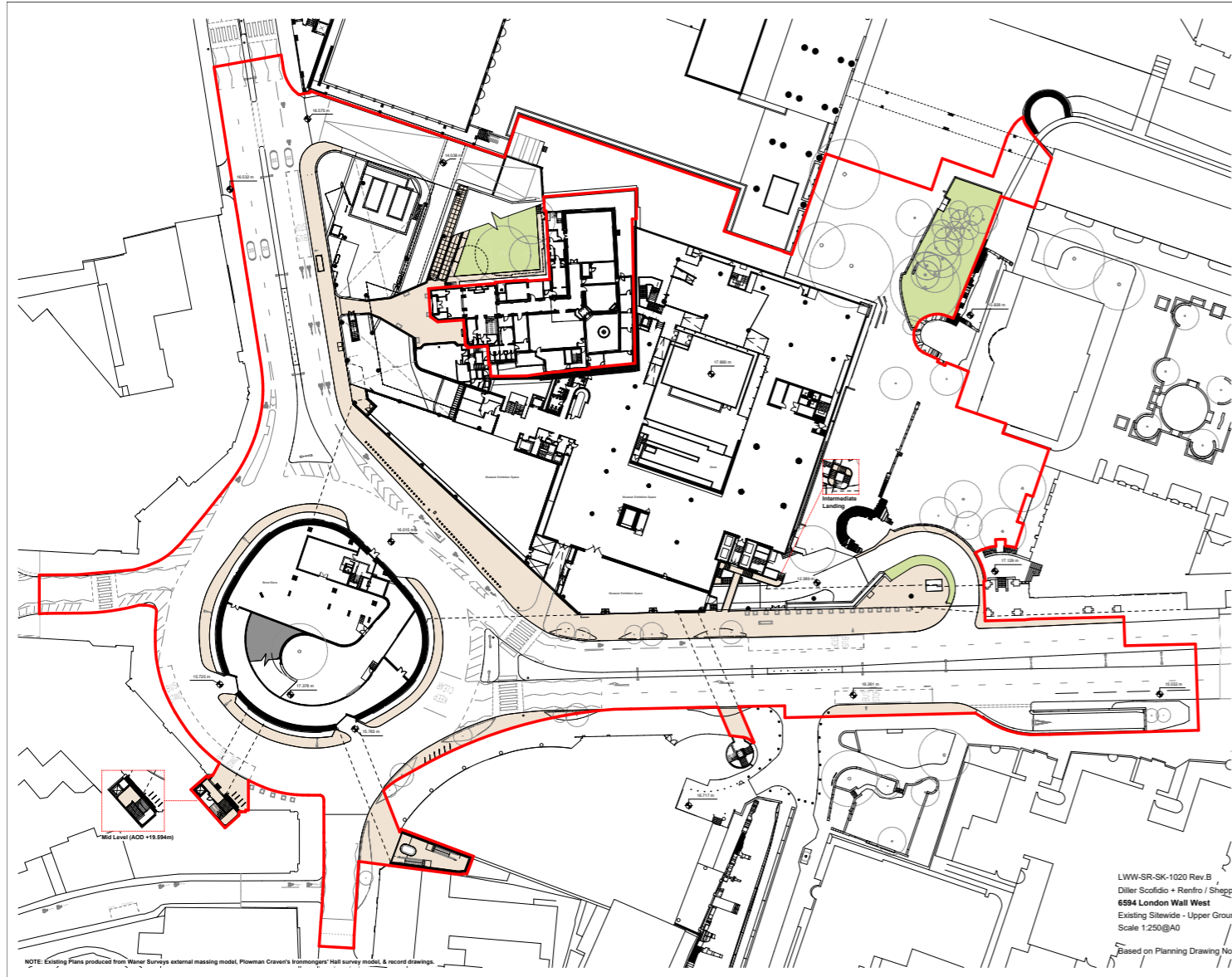

Existing

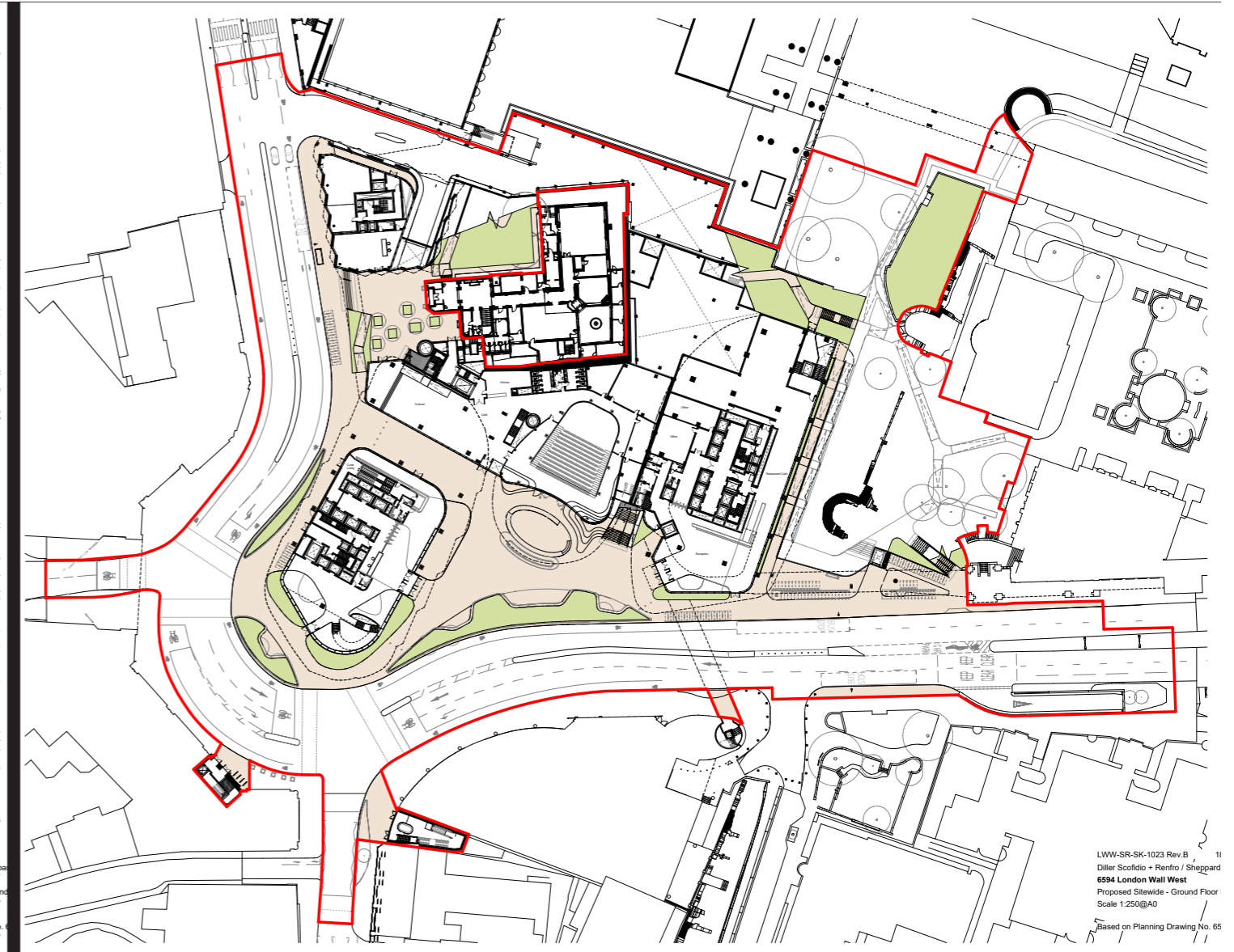

Proposed

- PUBLIC REALM**
- Landscape Area = 2,423 sqm
 - Hardscape Area = 360 sqm
 - Application Boundary for Planning Permission (Ground Floor and Below)

Public Realm Uplift

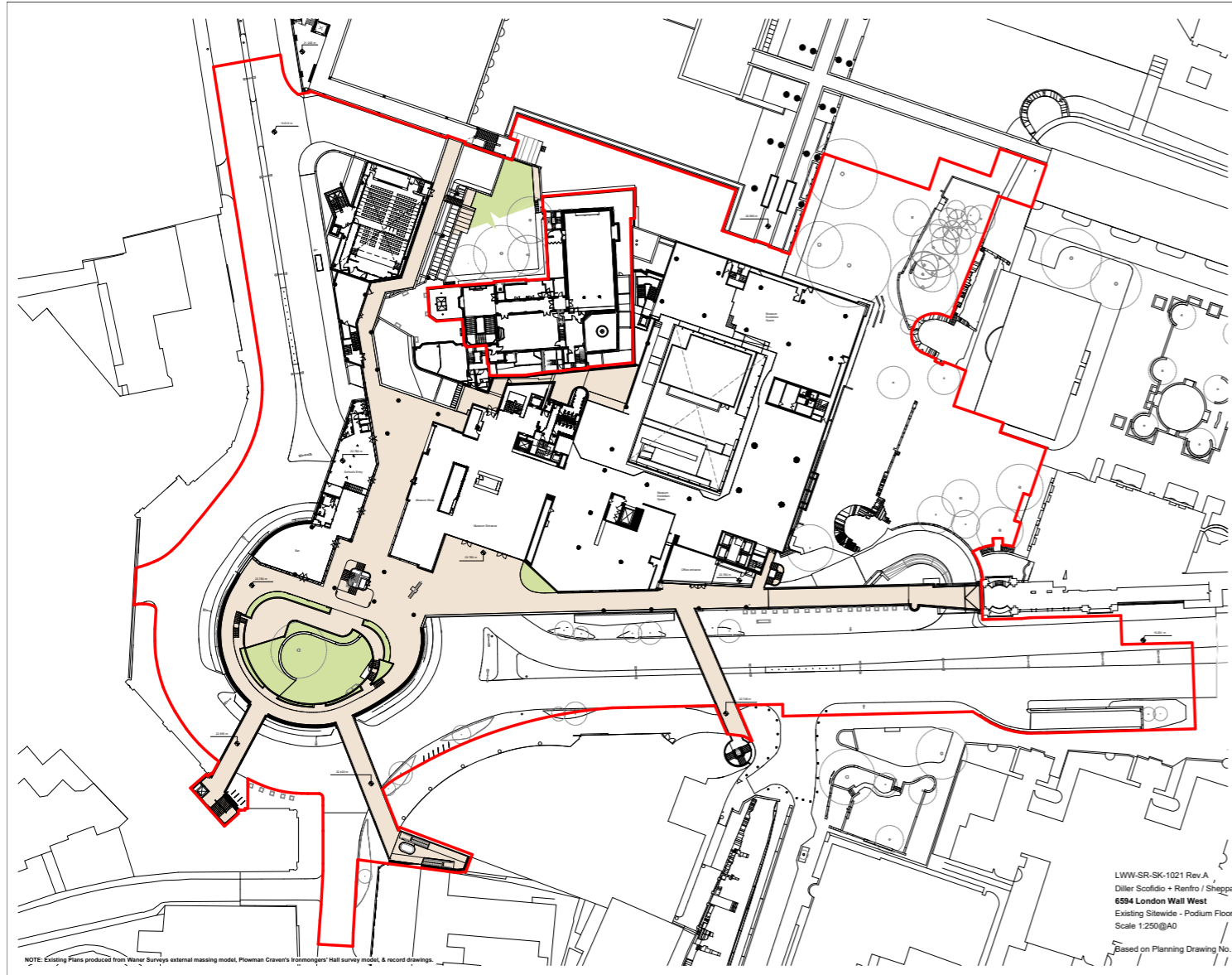

Existing

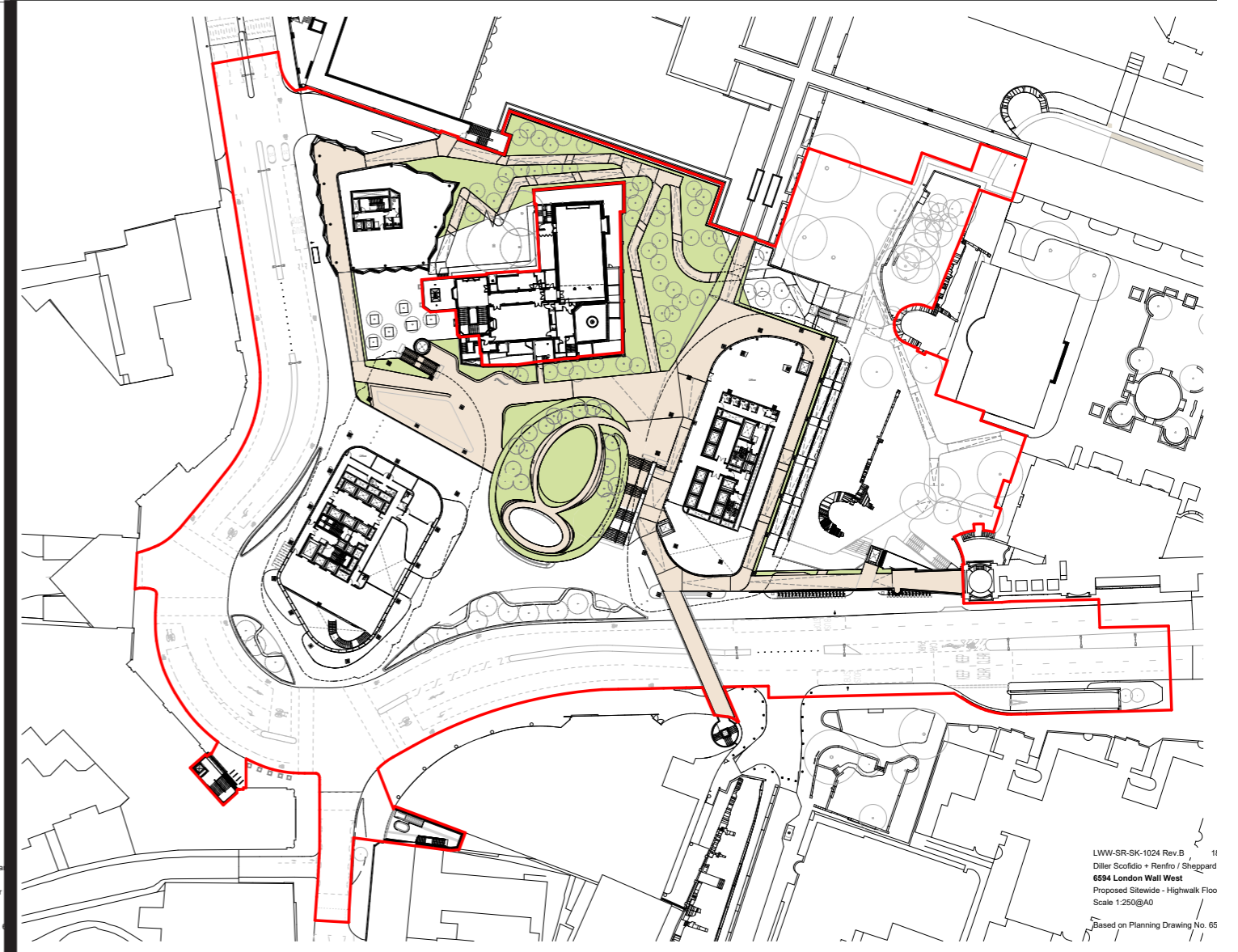

Proposed

- PUBLIC REALM**
- Landscape Area = 2,423 sqm
 - Hardscape Area = 360 sqm
 - Application Boundary for Planning Permission (Ground Floor and Below)

Access and Circulation

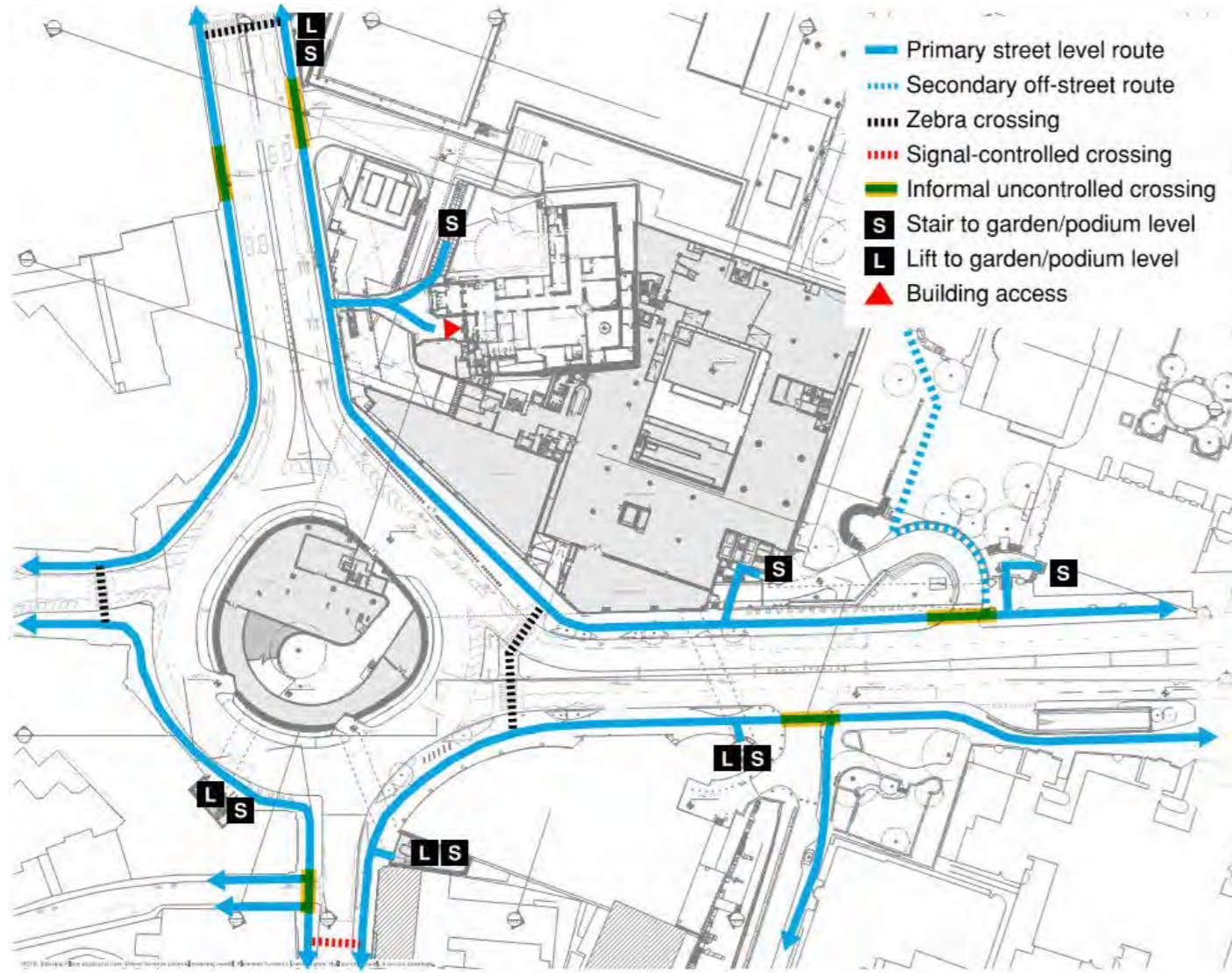

Existing

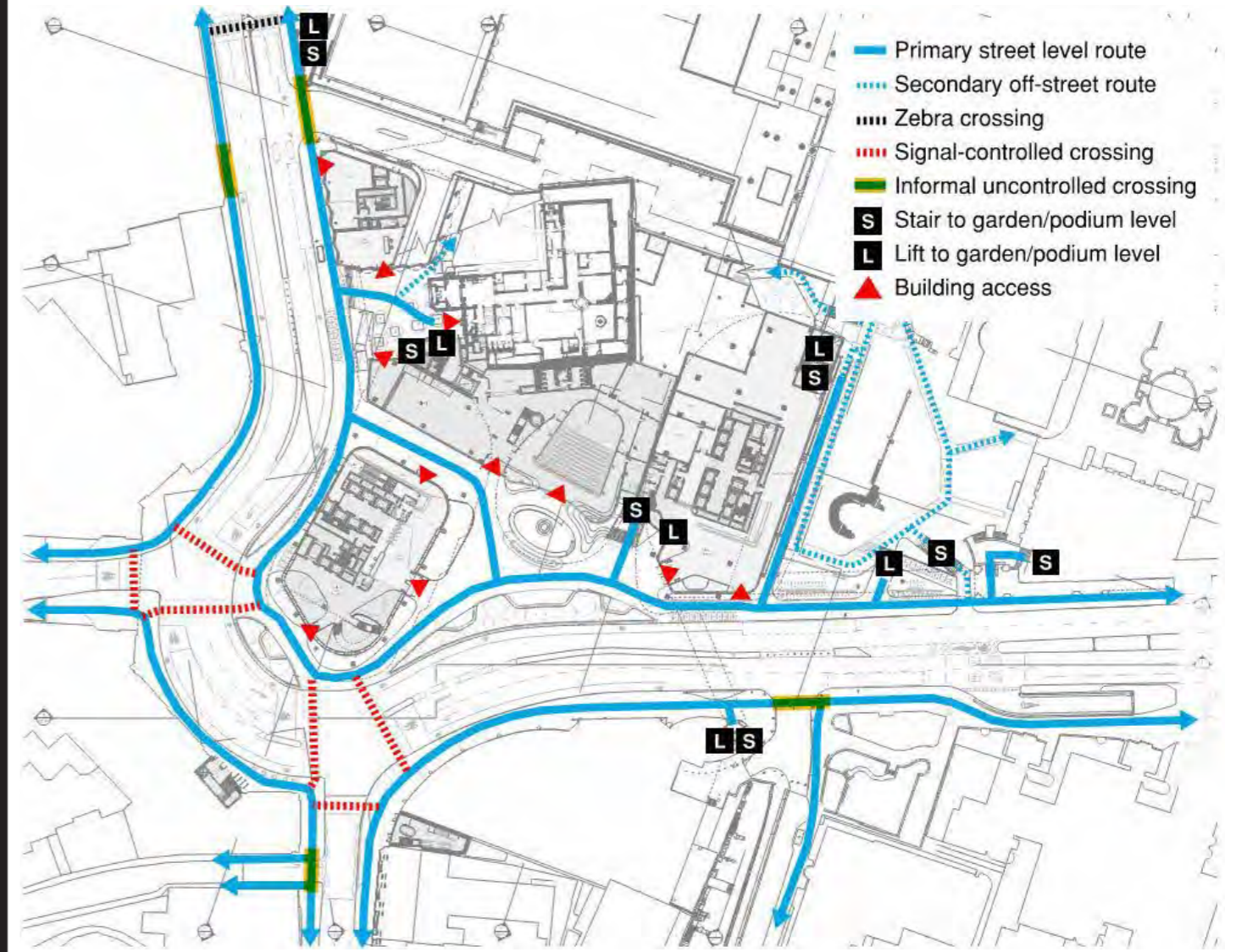

Proposed

Existing (left) and Proposed (right) Street level access and circulation

Access and Circulation

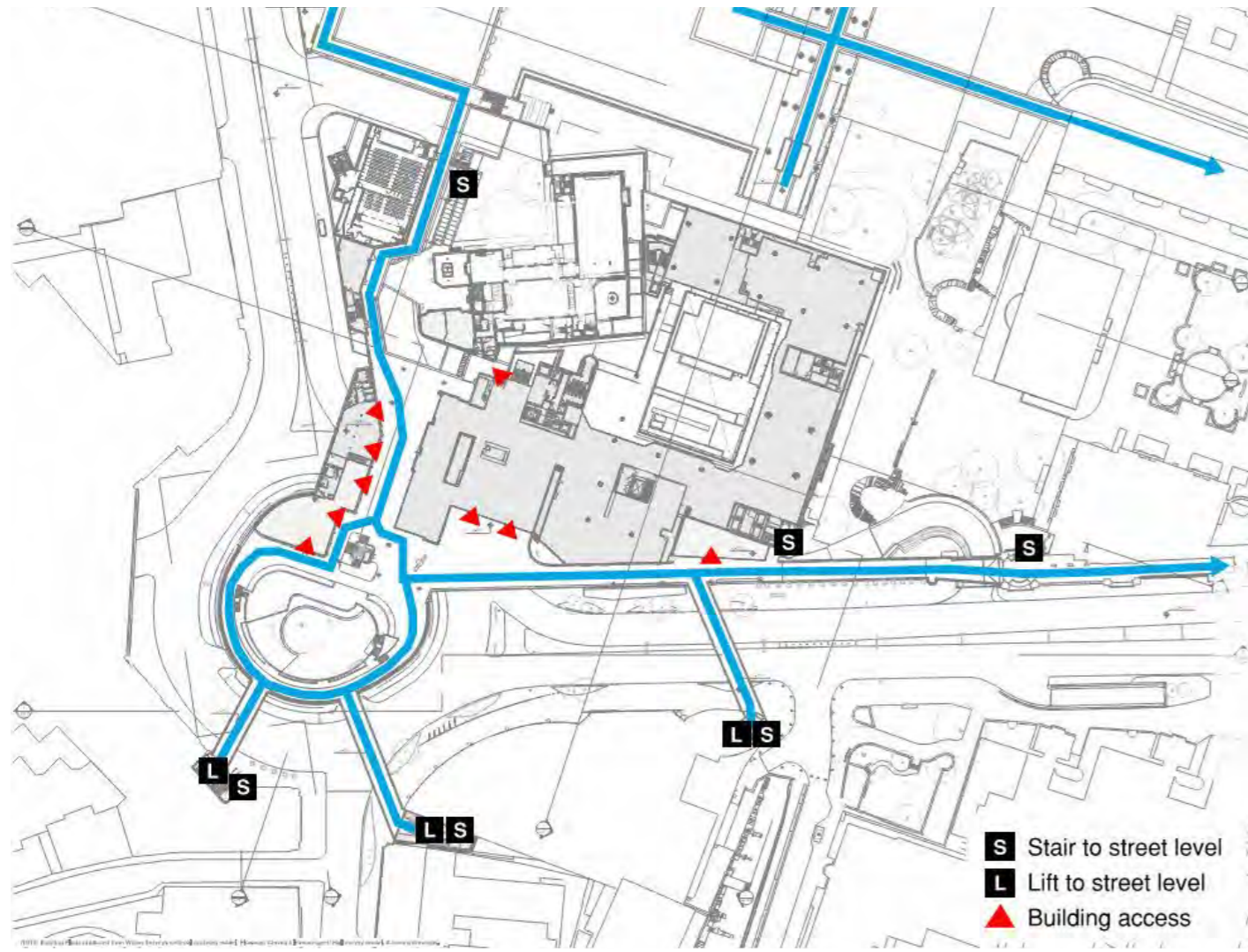

Existing

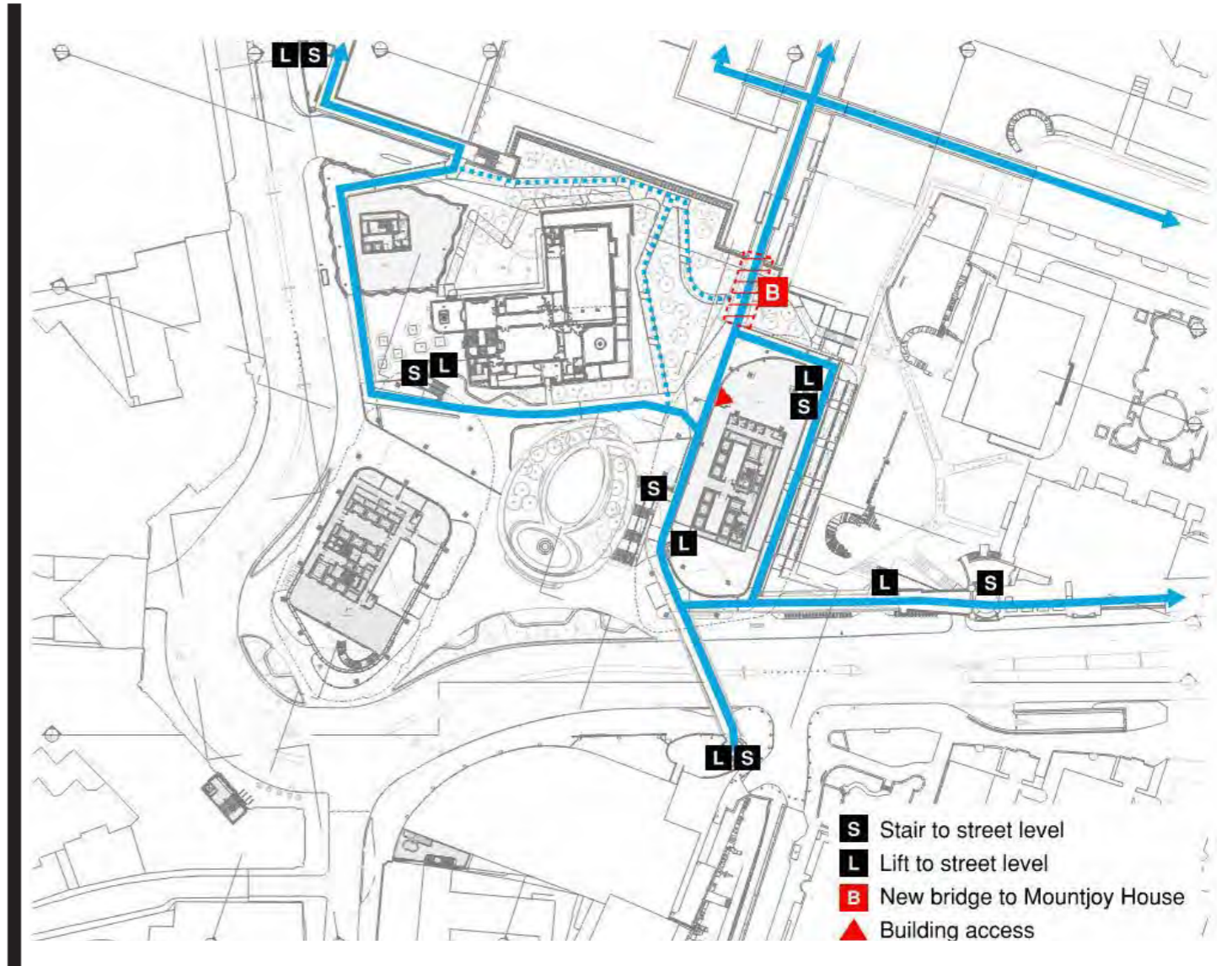

Proposed

Existing (left) and Proposed (right) Highwalk level access and circulation

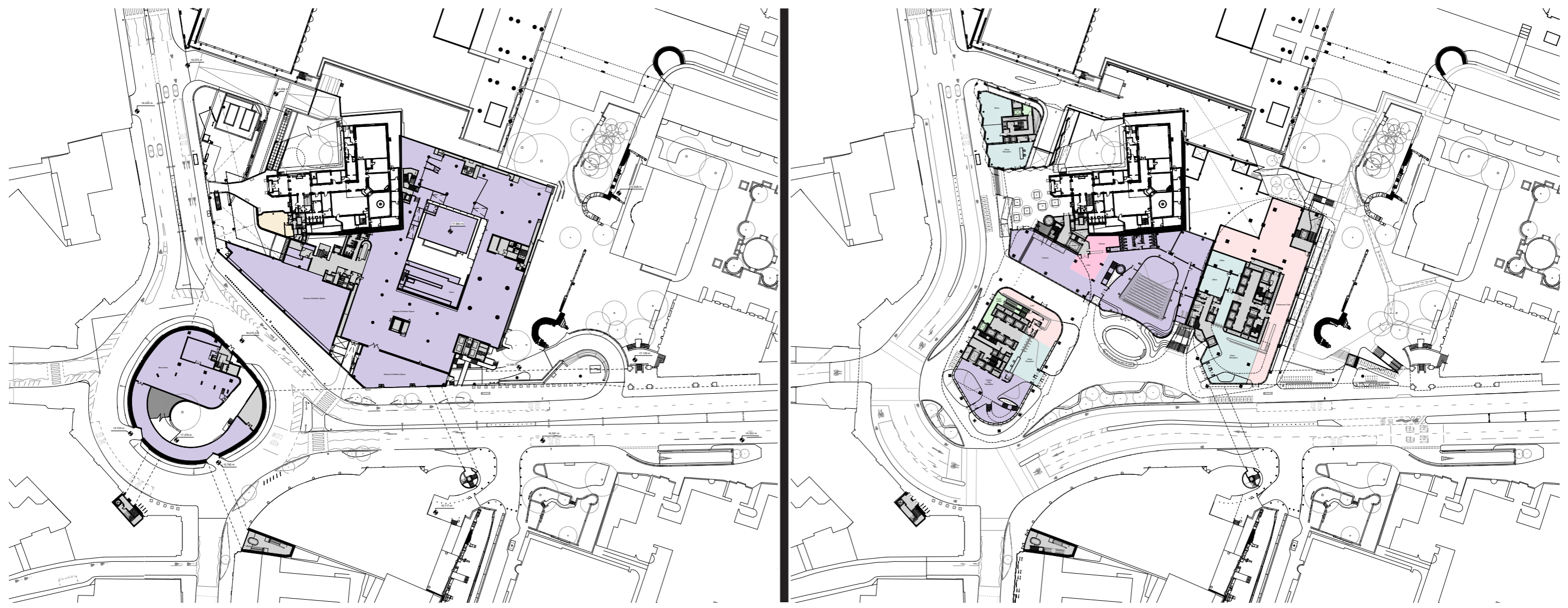

Existing

Proposed

- KEY
- Office
 - Cultural
 - Cultural Restaurant / Café
 - Restaurant / Café
 - Cycle Store
 - Shower / Changing Room
 - Livery Hall

Existing (left) and Proposed (right) Ground Floors

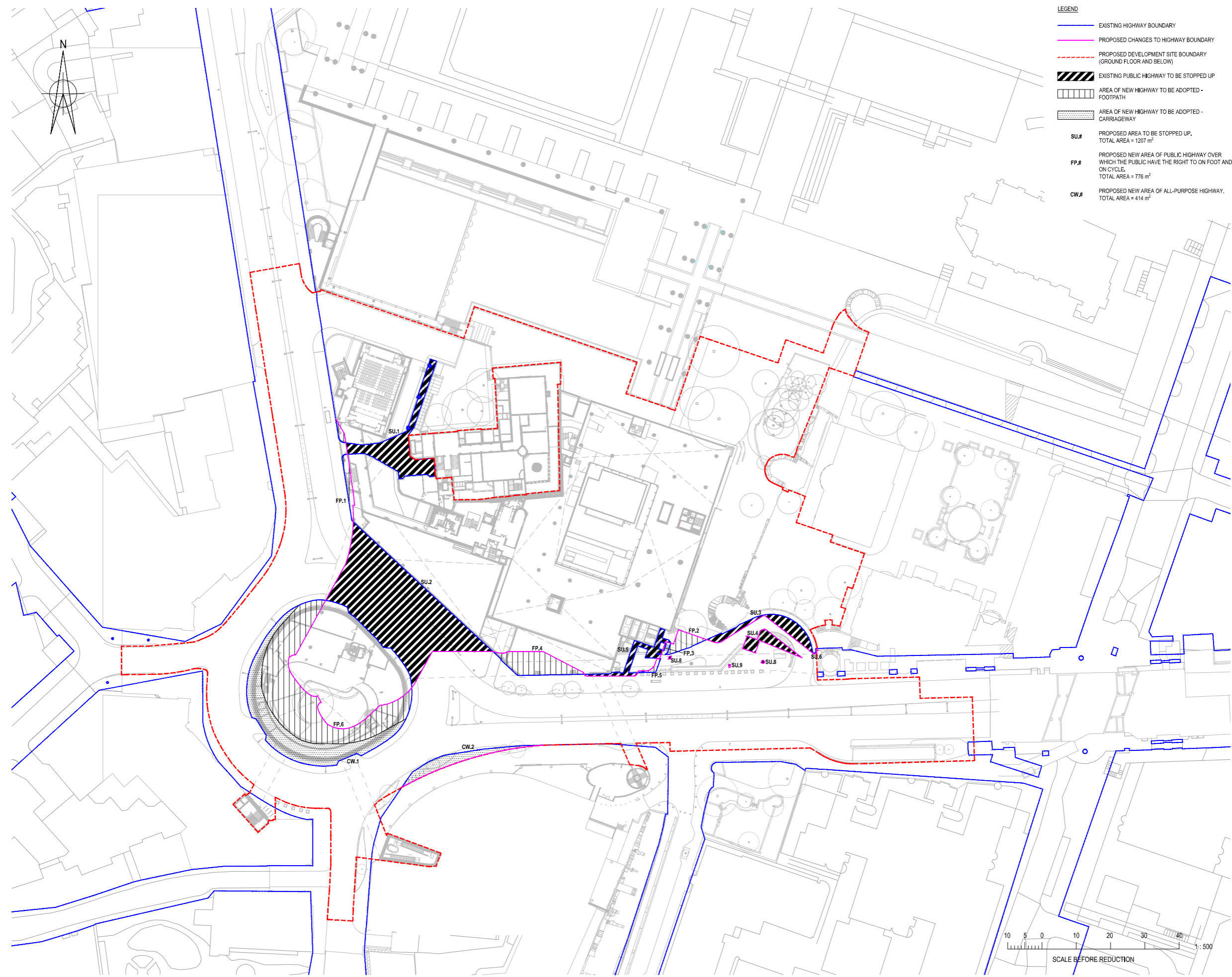

Stopping Up Drawing

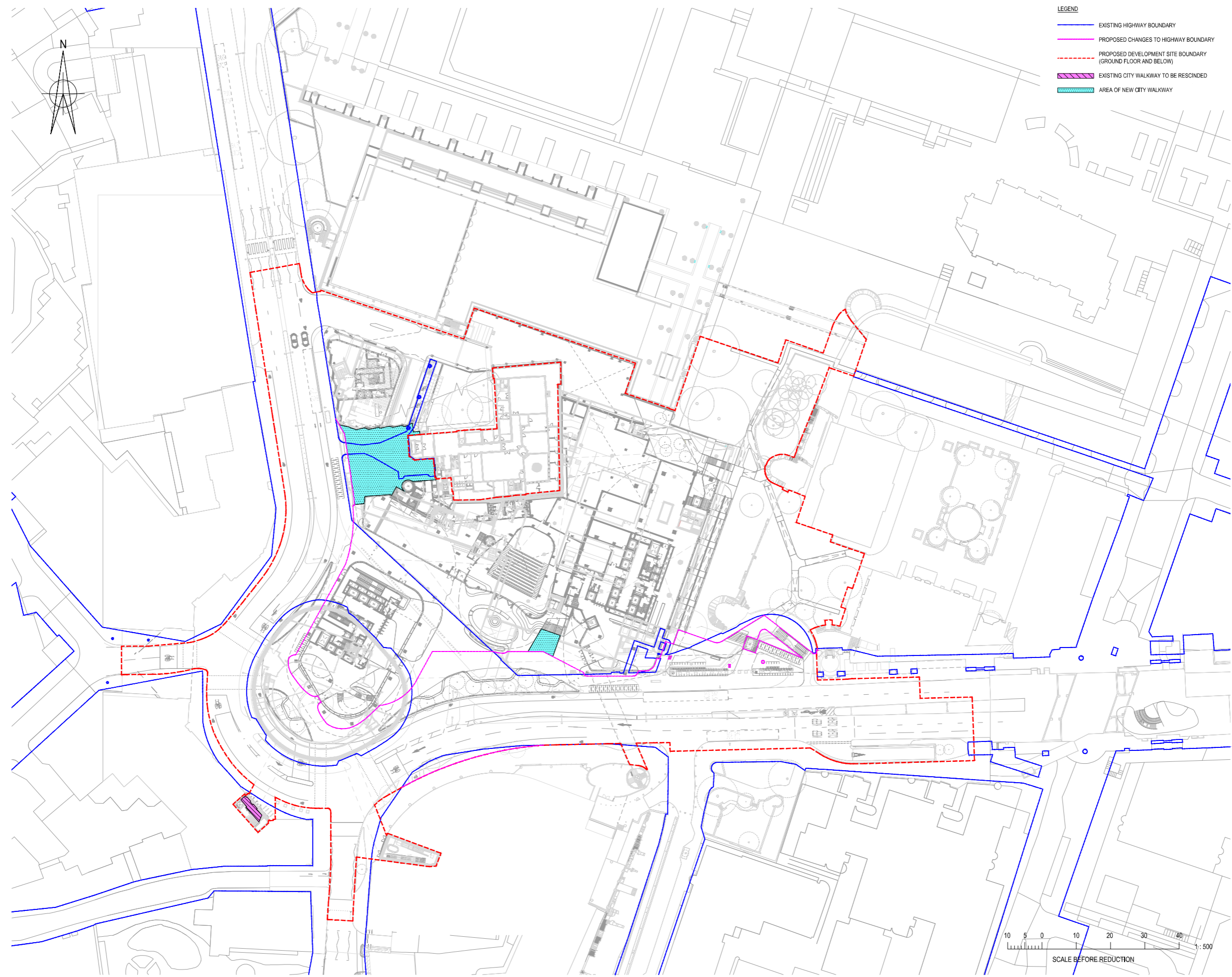

City Walkway Changes - Ground Level

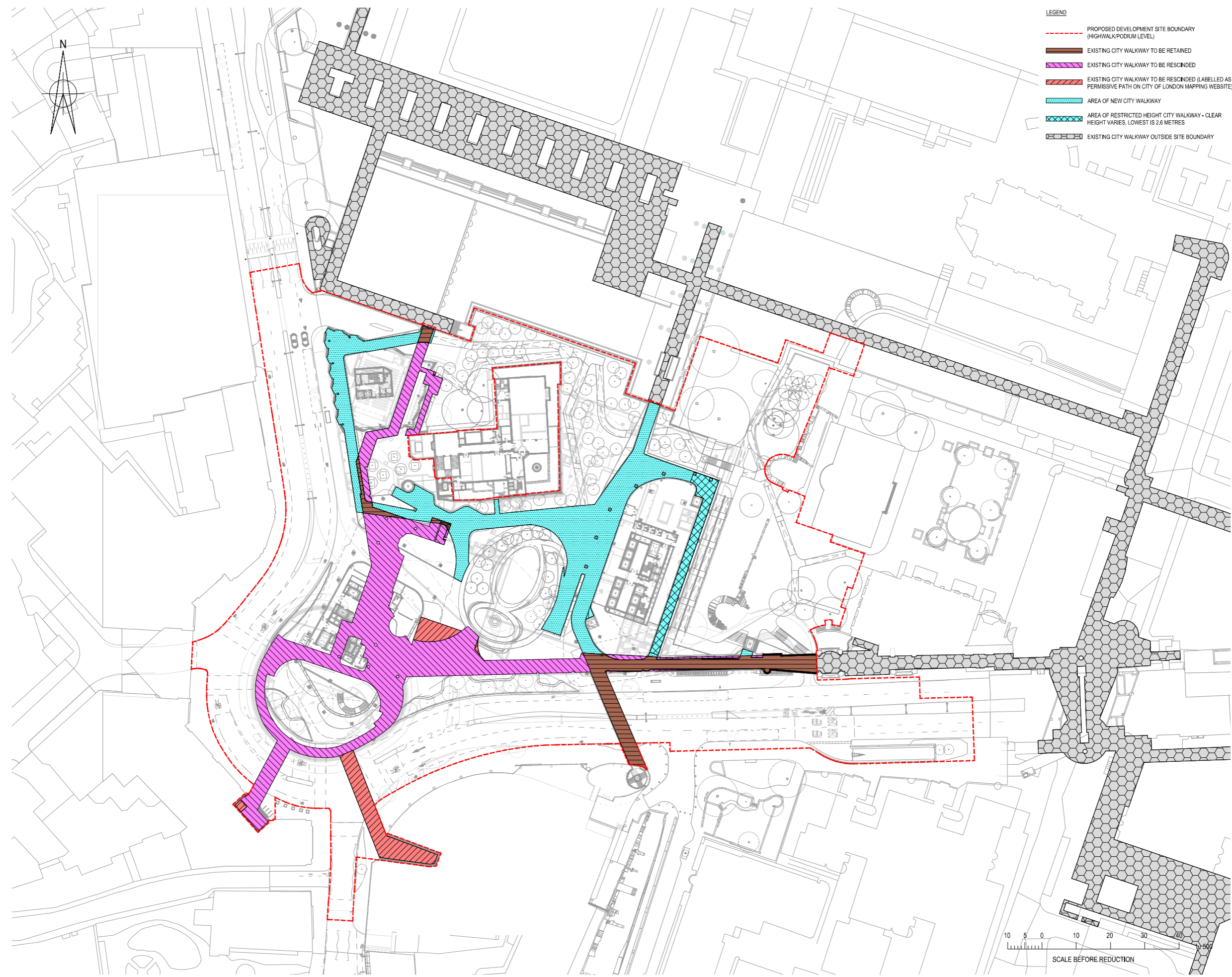

City Walkway Changes - Highwalk Level

Servicing & Waste - Existing

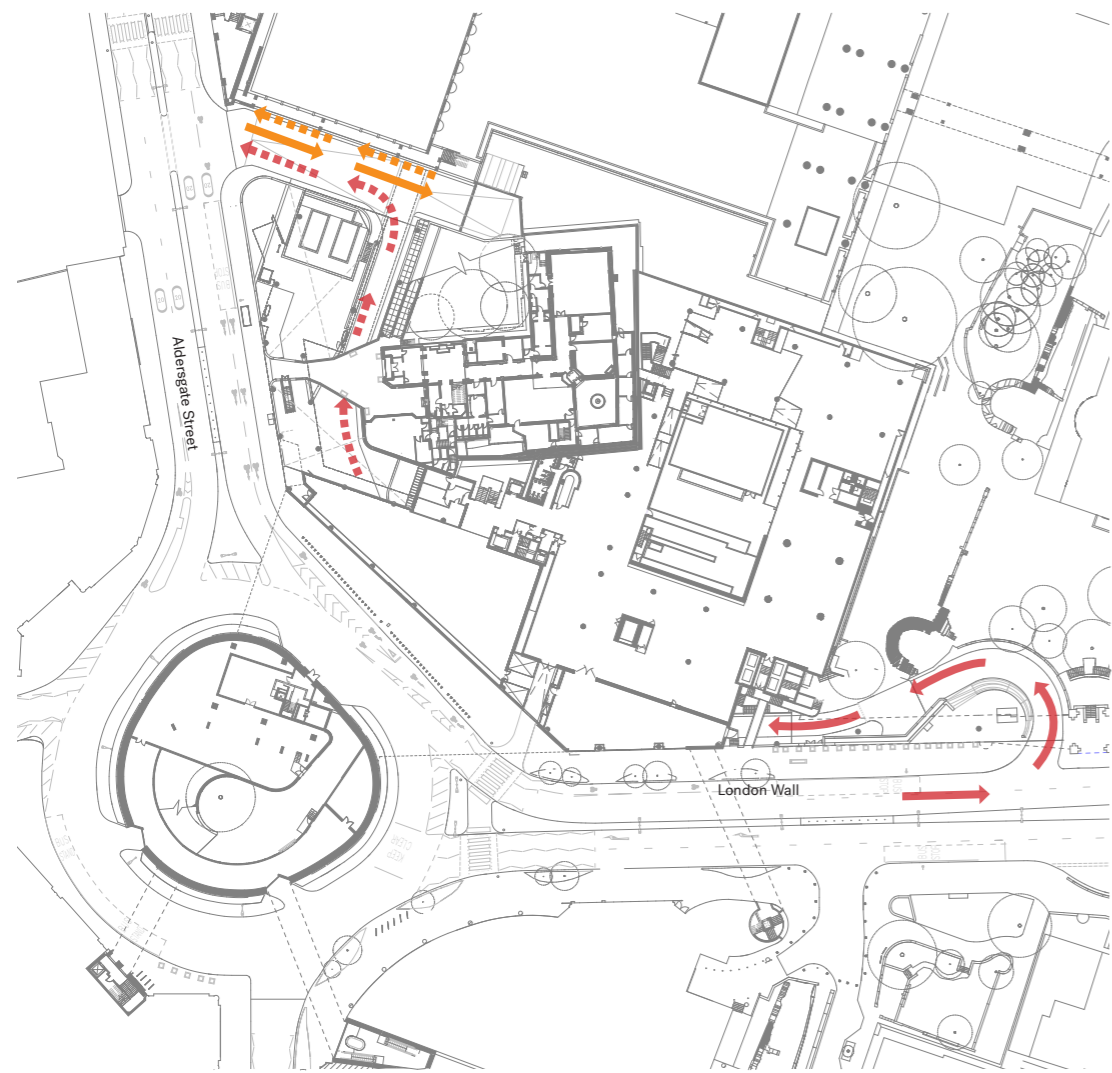

Ground Floor Level

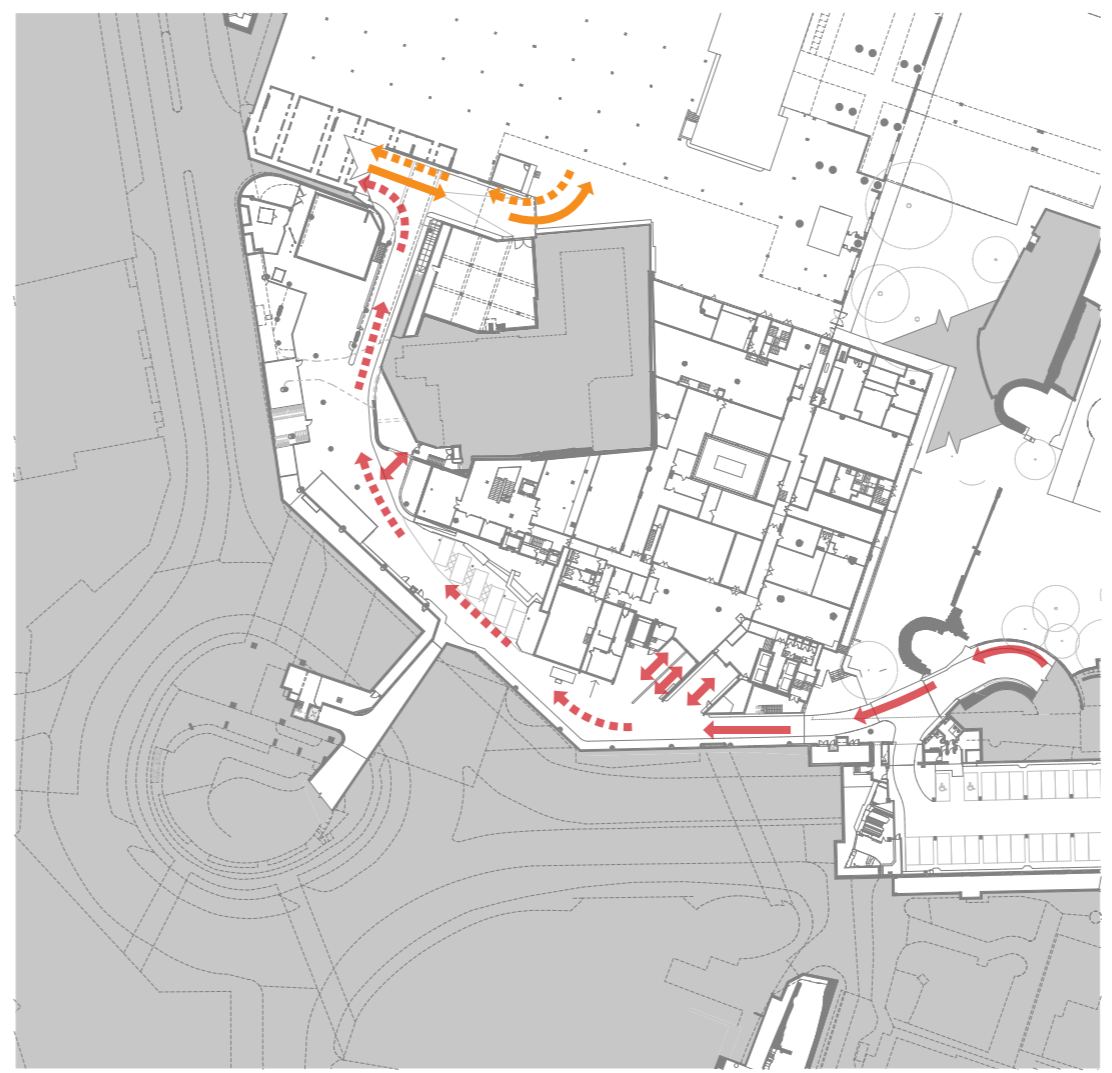

Lower Ground Floor Level

- KEY
- | | |
|--|-------------------------|
| Museum of London/Bastion House/
Ironmongers' Hall Service Route | Barbican Car Park Route |
| → Goods in | → Goods in |
| - - - Waste out | - - - Waste out |

Servicing & Waste - Proposed

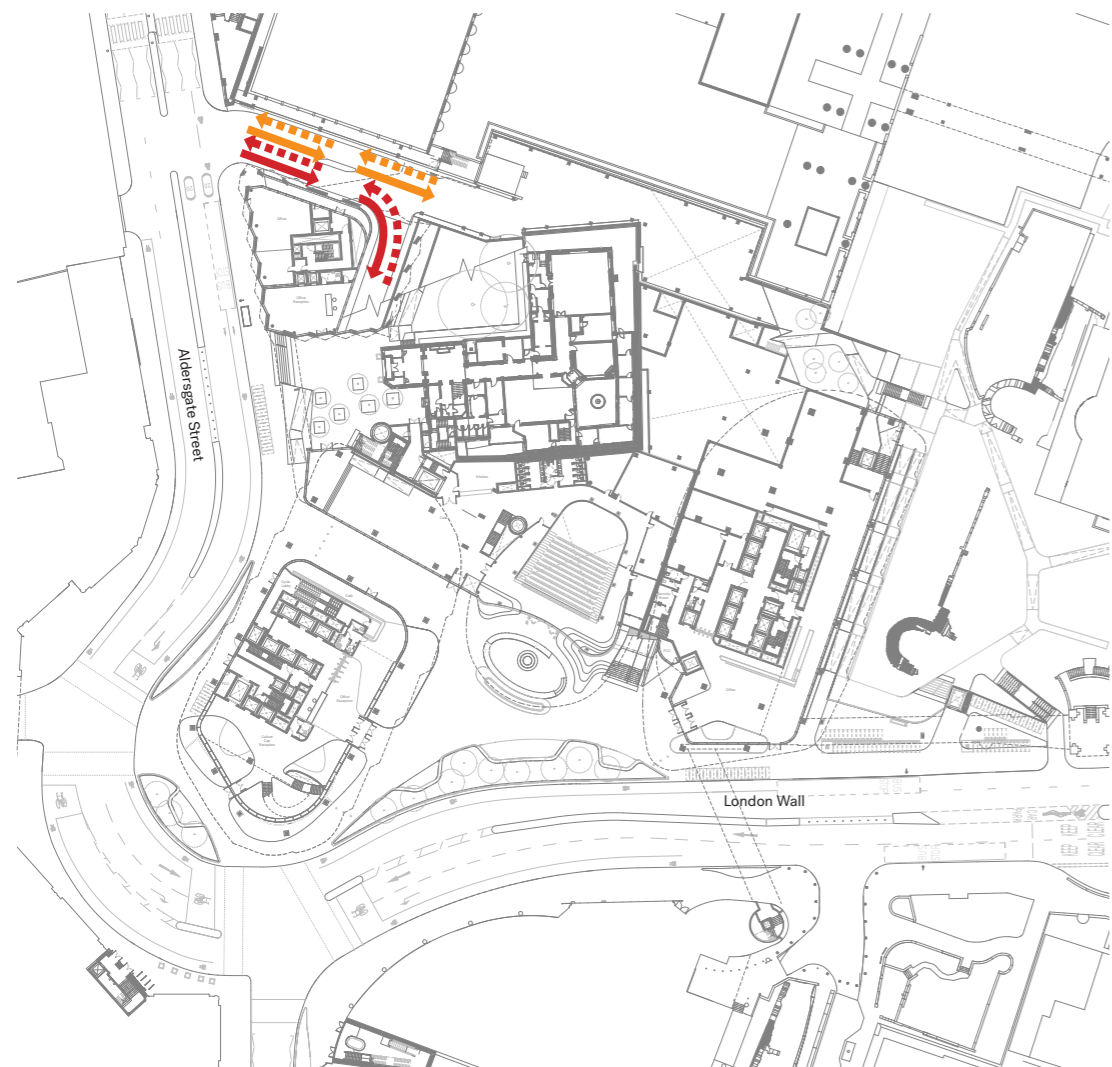

Ground Floor Level



Lower Ground Floor Level

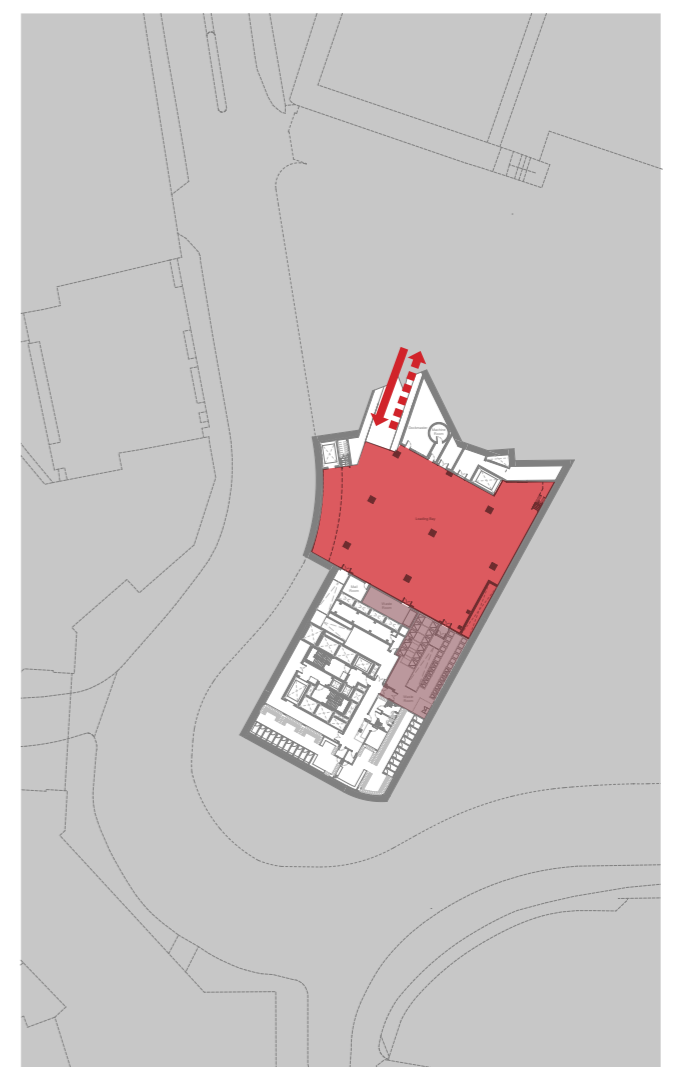

Rotunda Basement 1 Level

KEY

Proposed Service Route

- Goods in
- Waste out

- Loading Bay
- Waste Room

Barbican Car Park Route

- Goods in
- Waste out

Cycle Access

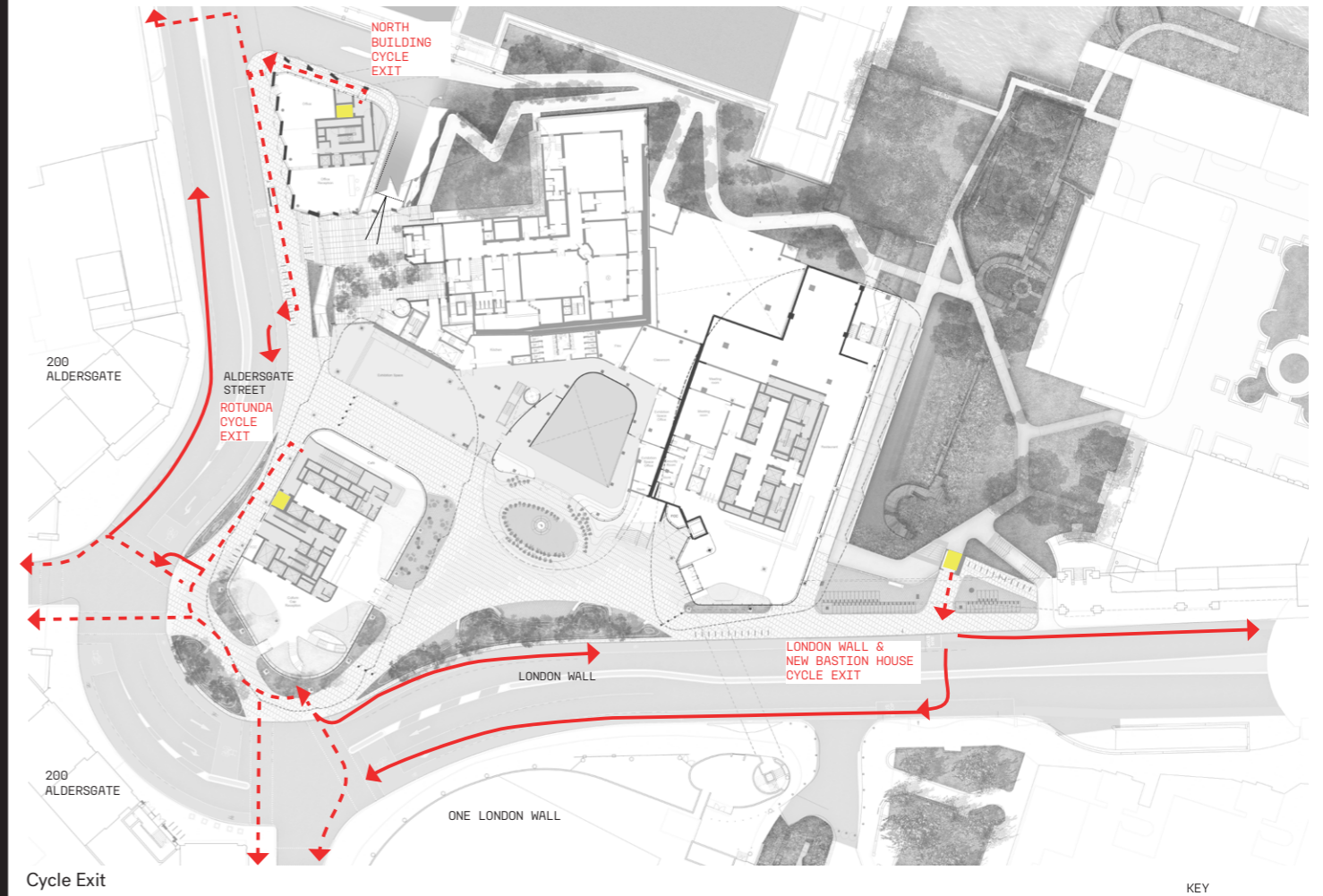
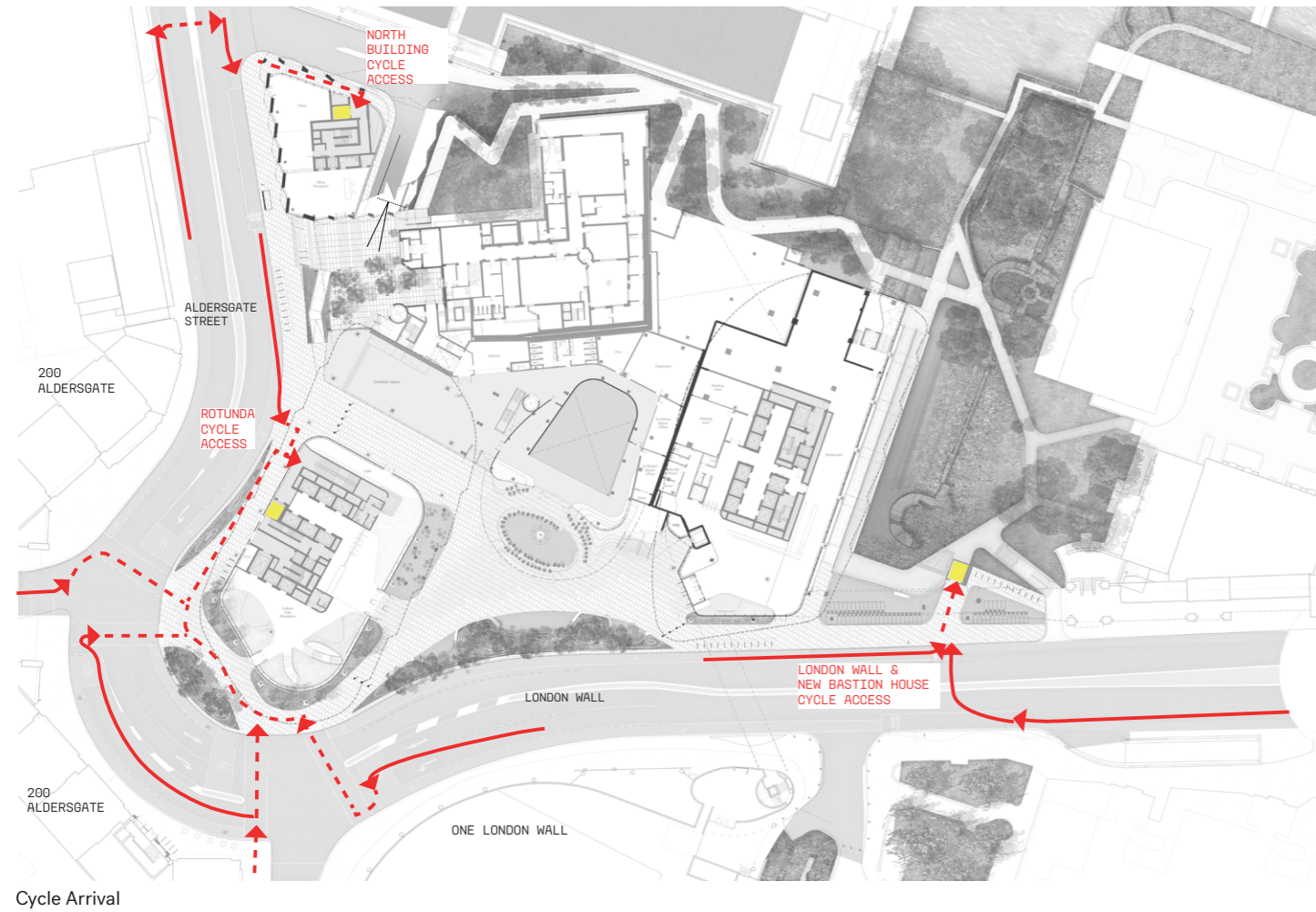

KEY
→ RIDE
- - - DISMOUNT
■ LIFTS

Floor Plans



Existing

Proposed

KEY

- Office
- Cultural
- Cultural Restaurant / Café
- Restaurant / Café
- Cycle Store
- Shower / Changing Room
- Livery Hall

Existing (left) and Proposed (right) Lower Ground Floor

Floor Plans



Existing

Proposed

KEY

- Office
- Cultural
- Cultural Restaurant / Café
- Restaurant / Café
- Cycle Store
- Shower / Changing Room
- Livery Hall

Existing (left) and Proposed (right) Basement 1

Floor Plans



Existing

Proposed

KEY

- Office
- Cultural
- Cultural Restaurant / Café
- Restaurant / Café
- Cycle Store
- Shower / Changing Room
- Livery Hall

Existing (left) and Proposed (right) Basement 2

Floor Plans



Existing

Proposed

KEY

- Office
- Cultural
- Cultural Restaurant / Café
- Restaurant / Café
- Cycle Store
- Shower / Changing Room
- Livery Hall

Existing (left) and Proposed (right) Mezzanine

Floor Plans

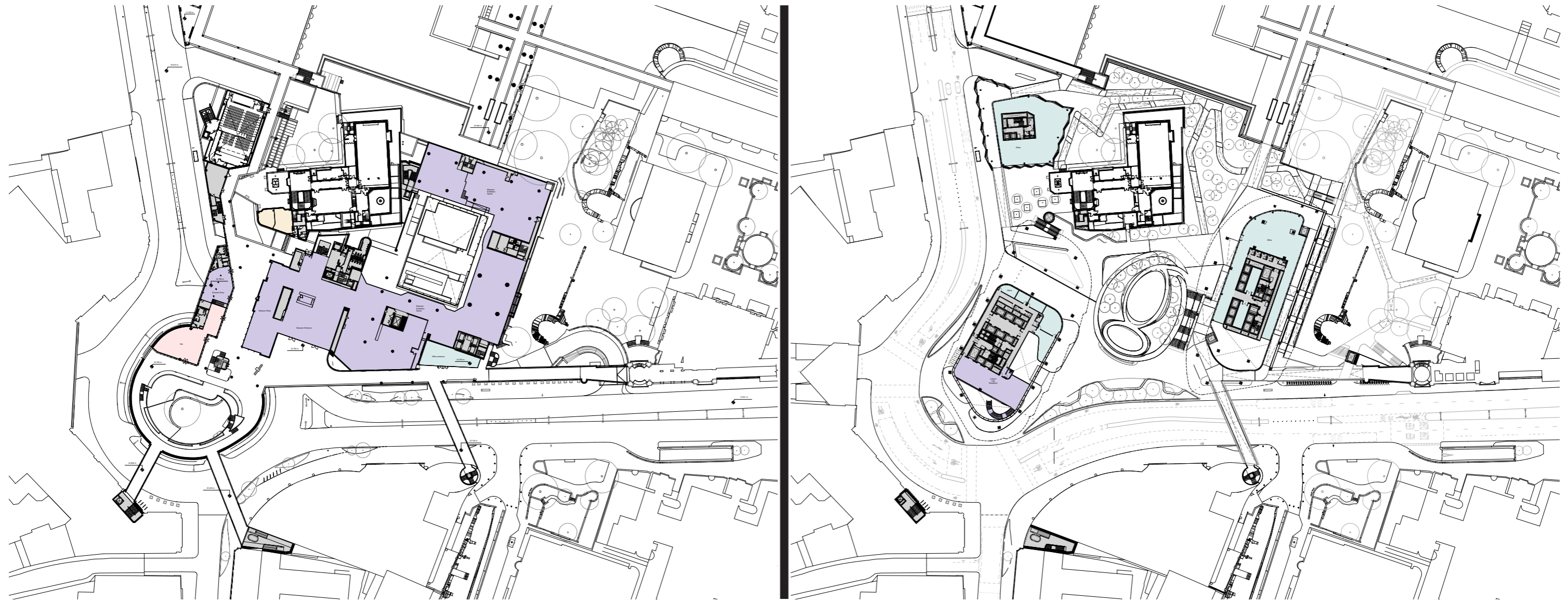

Existing

Proposed

- KEY
- Office
 - Cultural
 - Cultural Restaurant / Café
 - Restaurant / Café
 - Cycle Store
 - Shower / Changing Room
 - Livery Hall

Existing (left) and Proposed (right) Highwalk

Floor Plans



Existing

Proposed

- KEY
- Office
 - Cultural
 - Cultural Restaurant / Café
 - Restaurant / Café
 - Cycle Store
 - Shower / Changing Room
 - Livery Hall

Existing (left) Podium Mezzanine and Proposed (right) Highwalk

Floor Plans



Existing

Proposed

- KEY
- Office
 - Cultural
 - Cultural Restaurant / Café
 - Restaurant / Café
 - Cycle Store
 - Shower / Changing Room
 - Livery Hall

Existing (left) Second Floor and Proposed (right) Second Floor

Floor Plans

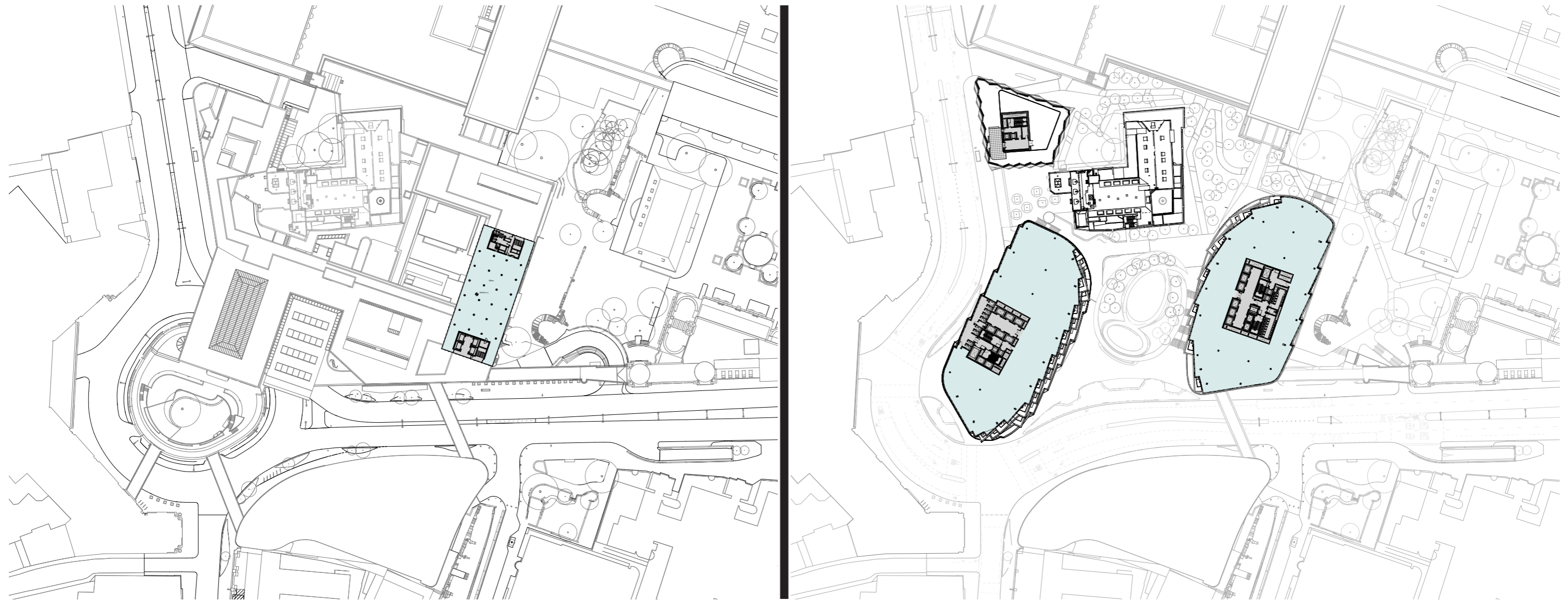

Existing

Proposed

- KEY
- Office
 - Cultural
 - Cultural Restaurant / Café
 - Restaurant / Café
 - Cycle Store
 - Shower / Changing Room
 - Livery Hall

Existing (left) Third and Proposed (right) Third Floor

Floor Plans



Existing

Proposed

KEY

- Office
- Cultural
- Cultural Restaurant / Café
- Restaurant / Café
- Cycle Store
- Shower / Changing Room
- Livery Hall

Existing (left) Typical Tower Floor and Proposed (right) 11th Floor

Floor Plans

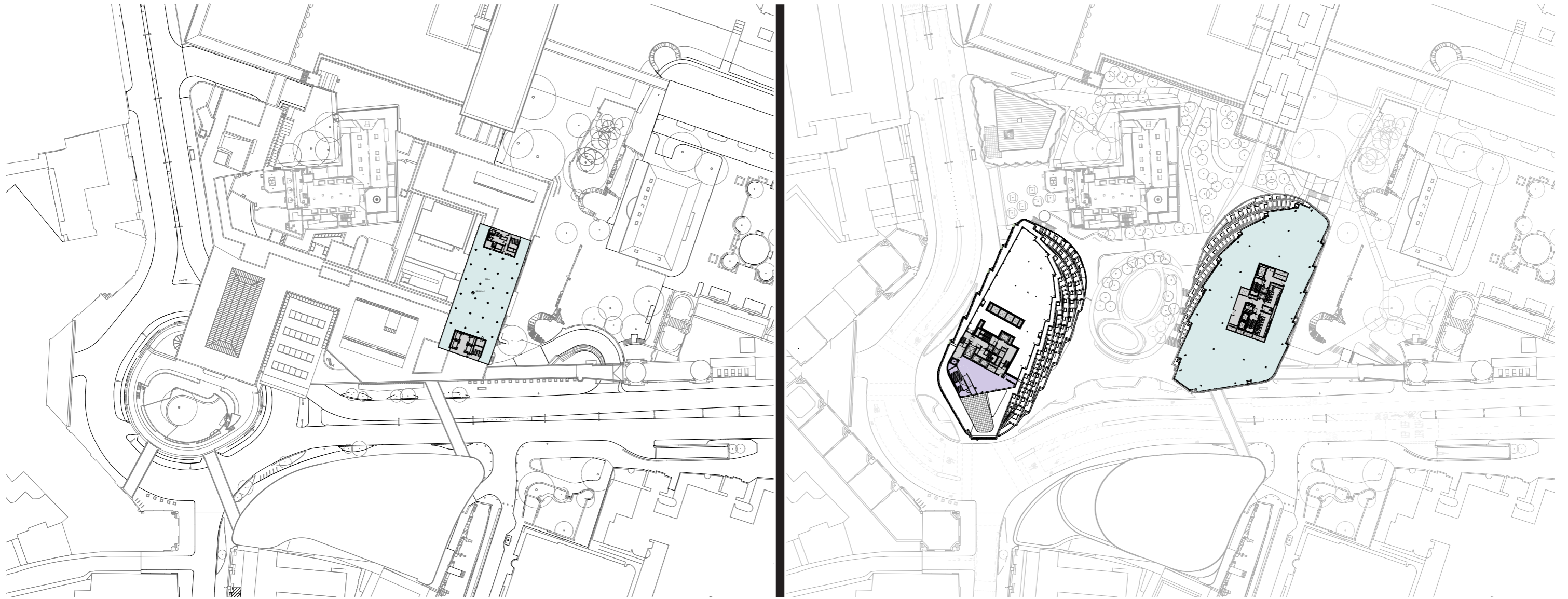

Existing

Proposed

KEY

- Office
- Cultural
- Cultural Restaurant / Café
- Restaurant / Café
- Cycle Store
- Shower / Changing Room
- Livery Hall

Existing (left) Typical Tower Floor and Proposed (right) 12th Floor

Floor Plans



Existing

Proposed

KEY

- Office
- Cultural
- Cultural Restaurant / Café
- Restaurant / Café
- Cycle Store
- Shower / Changing Room
- Livery Hall

Existing (left) 16th Floor and Proposed (right) 15th Floor

Floor Plans

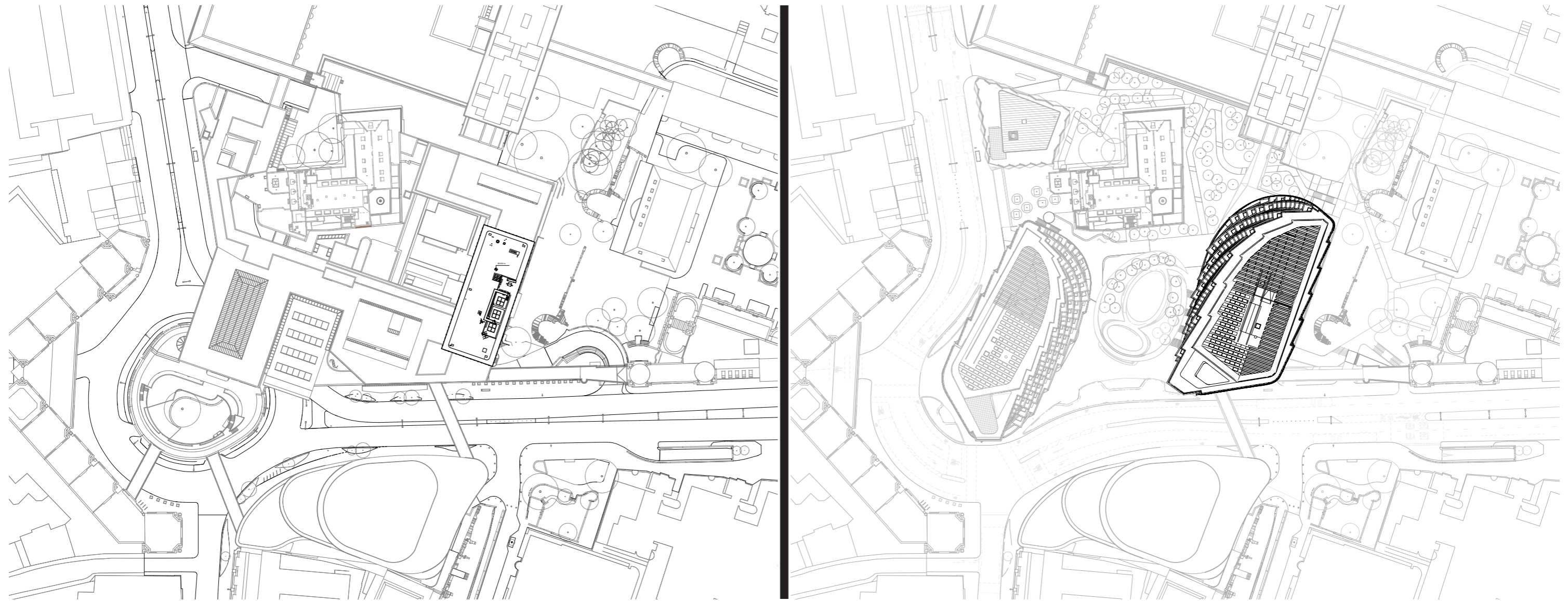

Existing

Proposed

KEY

- Office
- Cultural
- Cultural Restaurant / Café
- Restaurant / Café
- Cycle Store
- Shower / Changing Room
- Livery Hall

Existing (left) and Proposed (right) Roof Plan

Typical Cross Sections

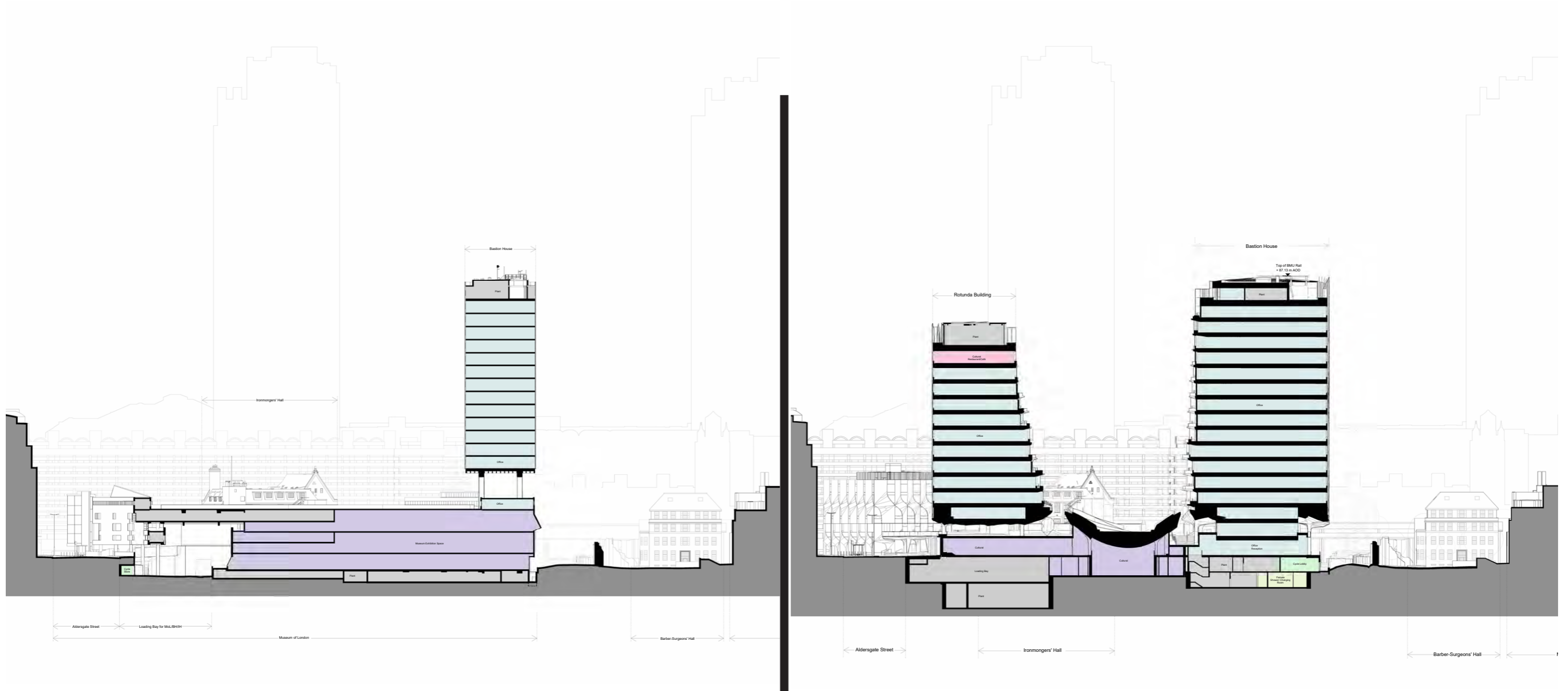

Existing

KEY

- Office
- Cultural
- Cultural Restaurant / Café
- Restaurant / Café
- Cycle Store
- Shower / Changing Room
- Livery Hall



Proposed

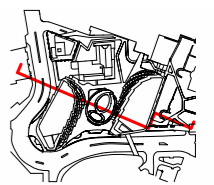

Existing (left) and Proposed (right) Section East-West